

R I V E T

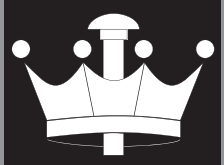

K I N G®

SupraTITE®

BLIND RIVETS



Excellence.

Strength.

Security.

Available in
Aluminum and Steel

ALUMINUM SUPRATITE - DOME, LOW PROFILE, LARGE FLANGE AND RECESSED CROWN HEADS

Often used in the truck trailer industry, to join very thin sheets of aluminum or steel, where there isn't access on both sides of the application. It is also used to laminate trailer body skin from one side of the trailer.

FEATURES:

- Split Tail formation spreads the tail bearing load on the rear sheet.
- It's ideal for use in thin materials, and has excellent and multigrip range.
- The retained stem provides a very strong, vibration resistant joint.

ASSEMBLY MATERIALS:

Metal to Plastic, Plastic to Plastic, Plastic to Metal, Metal to Metal

TYPICAL APPLICATION:

Domestic Appliances, Plastic Components, Automotive, Trailers, RV, Sporting Goods

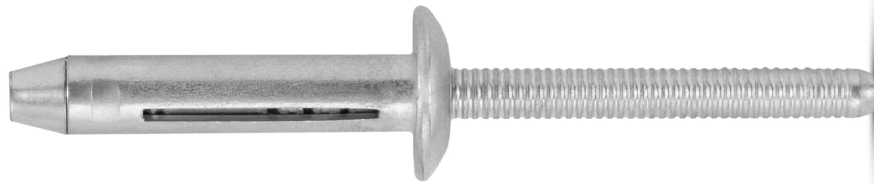

Neoprene or EPDM washer optional and indicated by "W" suffix

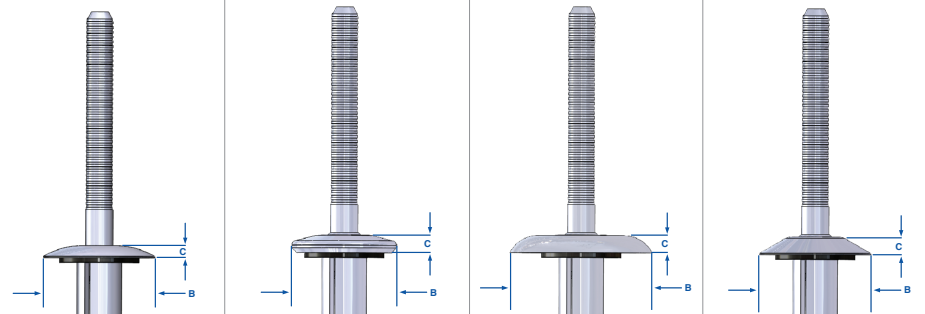

ATT02 LOPRO FLAT HEAD	ATT04/ATT03 DOME HEAD PROTRUDING CROWN	ATT05 LARGE FLANGE PROTRUDING CROWN	ATT06 DOME HEAD RECESSED CROWN
--------------------------	--	---	--------------------------------------

NOM. SIZE	GRIP CODE	GRIP RANGE	HOLE SIZE	UHL	SHEAR LBS (TYP.)	TENSILE LBS (TYP.)	PART CODE	B		C		PART CODE	B		C		PART CODE	B		C	
								HEAD DIA	HEAD HEIGHT	HEAD DIA	HEAD HEIGHT		HEAD DIA	HEAD HEIGHT	HEAD DIA	HEAD HEIGHT		HEAD DIA	HEAD HEIGHT		
5/32"	5-4	.125 - .250 *.067 - .250	.162/.167 (#20)	.862	160 *350	225	ATT02-5-4	.355 - .375	.057	*ATT04-5-4	.335 - .350	.100									
	5-6	.187 - .375		ATT02-5-6			ATT04-5-6														
	5-8	.250 - .500		ATT02-5-8			ATT04-5-8														
3/16"	6-4	.125 - .250 *.062 - .250	.209/.221 (#4)	.935 *.907	400 *675	450	ATT02-6-4	.430 - .455	.062	*ATT04-6-4	.430 - .455	.125									
	6-6	.187-.375		ATT02-6-6			*ATT04-6-6														
	6-8	.250-.500 *.312 - .500		ATT02-6-8			*ATT04-6-8														
	6-10	.375 - .625 *.437 - .625		ATT02-6-10			*ATT04-6-10														
	6-12	.500 - .750 *.563 - .750		ATT02-6-12			*ATT04-6-12														
	6-14	.750-.875		ATT02-6-14			ATT04-6-14														
	6-16	.875-1.000		ATT02-6-16			ATT04-6-16														
	6-18	1.000-1.125		ATT02-6-18			ATT04-6-18														
	6-18	1.000-1.125		ATT02-6-18			ATT04-6-18														
1/4"	8-4	.125-.250 *.062/#.040 -.250	.250-.263 (1/4")	1.005	950	575	ATT02-8-4	.532 - .542	.070	*ATT04-8-4	.555 - .565	.150									
	8-6	.187-.375 *.125-.375		ATT02-8-6			*ATT04-8-6														
	8-8	.250-.500		ATT02-8-8			ATT04-8-8														
	8-10	.375-.625		ATT02-8-10			ATT04-8-10														
9/32"	9-3	.032-.187	.304-.3125 (5/16)	1.000	1500	1100				*ATT05-9-3	.610 - .620	.190									
	9-6	.032-.375 *.042-.375					*ATT05-9-6														
	9-10	.250-.625		308-.327* (5/16)			*ATT05-9-10														
	9-12	.375-.750					*ATT05-9-12														

ALUMINUM SUPRATITE - COUNTERSUNK AND SHAVEABLE BRAZIER HEADS



The shaveable series is designed for the mandrel to break high, and be cut off with a snipping tool. After snipping, the head can be shaved to match the appearance of solid brazier head rivets commonly used on trailers.

Neoprene or EPDM washer optional and indicated by "W" suffix

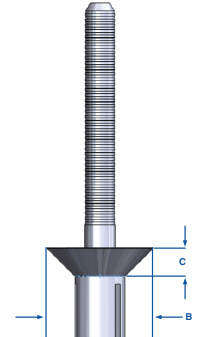
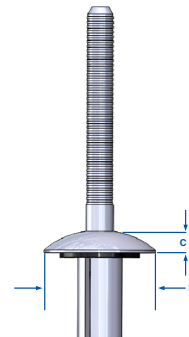

BOLT	GRIP CODE	GRIP RANGE	HOLE SIZE	UHL	SHEAR LBS (TYP.)	TENSILE LBS (TYP.)	ATT07 SHAVE HEAD			ATT01 COUNTERSUNK HEAD		
							PART CODE	B HEAD DIA	C HEAD HEIGHT	PART CODE	B HEAD DIA	C HEAD HEIGHT
5/32"	5-5	.020-.312	.162/.167 (#20)	.920	350	225	ATT07-5-5	.296 - .328	.077			
3/16"	6-3	.020-.187	.209/.221 (#4)	.872	675	450	ATT07-6-3	.446 - .492	.105	ATT01-6-3	.340 min	.108
	6-4	*.050-.250 *.106 - .250		.935			*ATT01-6-4					
	6-6	*.050-.375 *.187 - .375		1.060			*ATT01-6-6					
	6-8	.050 - .500 *.312 - 500		1.185			*ATT01-6-8					
	6-10	*.050 - .625 *.437 - .625		1.310			*ATT01-6-10					
	6-12	*.050 - .750 *.563 - .750		1.435			*ATT01-6-12					
1/4"	8-4	.150-.250	.250-.263 (1/4")	1.005	900 *950	550 *575				ATT01-8-4	.452 min	.164
	8-4	.187-.375		1.310			ATT01-8-6					
	8-6	.250 - .500 *.050 - .500		1.255			*ATT07-8-8	ATT01-8-8				

STEEL SUPRATITE - DOME AND COUNTERSUNK HEADS

Are commonly used in truck trailer when fastening skins to vertical or lateral frames. Steel Supratite can also be used in structural supports for metal buildings or securing panels for AC units, or on uni-strut.

Neoprene or EPDM washer optional and indicated by "W" suffix

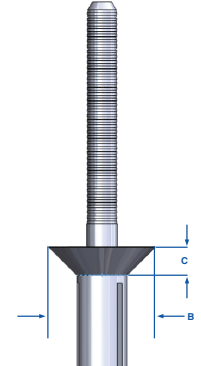
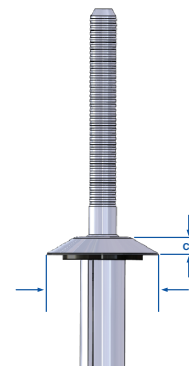

NOM. SIZE	GRIP CODE	GRIP RANGE	HOLE SIZE	UHL	SHEAR LBS (TYP.)	TENSILE LBS (TYP.)	STT76 DOME HEAD			STT71 COUNTERSUNK HEAD		
							PART CODE	B HEAD DIA	C HEAD HEIGHT	PART CODE	B HEAD DIA	C HEAD HEIGHT
1/4"	8-4	.040-.250 *.150-.250	.250-.263 (1/4")	1.005	1250	950	STT76-8-4	.535 - .550	.125	STT71-8-4*	.477 - .485	.165
	8-6	.125-.375 *.187-.375		1.130			STT71-8-6*					
	8-8	.250-.500		1.255 1.355*			STT71-8-8*					
	8-10	.375-.625		1.380			STT76-8-10					



Industrial Rivet & Fastener Company
200 Paris Avenue Northvale, NJ 07647
1-800-289-7483 (1-800-BUY-RIVET)

O: 201-750-1040 **F:** 201-750-1050

E: info@rivet.com

You can access our catalog online at:

www.rivet.com

WWW.RIVETKING.COM